

S5-Series

2 Person Infrared Sauna IL2 and Bluetooth

S825 & 830 User Manual



This Product is covered by:
 US Patents No. 8,692,168
 Canadian Patents No. 2,729,500
 2,794,059 & 2,813,340
 and other Patents Pending.

Precautions Before Use	2
Preassembly Information	2
Electrical Requirements	3
Sauna Assembly	4
Electrical Connection-Under Bench	8
Electrical Connection-Inside Ceiling	12
Control Panel Instructions	14
Lighting Operation	15
Audio System	15
Wi-Fi Pairing Information	16
How to Use Sauna	17
Tips & Troubleshooting	18
Wiring Diagram	19
Warranty	20

Precautions before Use: Warning (Room Configuration & Use):

- Proper Electrical Grounding is Required
- Electrical Receptacles not Allowed in the Room
- Do not Apply Water to any Heating Element
- Do not Add a Locking or Latching System to the Door
- Do not Block Ventilation Openings
- Children Must be Supervised at all Times in the Sauna

CAUTION: Loose wire connections can cause heat damage to wires, terminal blocks and other components and may void the warranty.

Electrical Caution – Do not plug the room power cord into an electrical outlet until Room Assembly is completed!

a. Warning (Human Limitations):

Prolonged Exposure at Elevated Temperatures May Cause Hyperthermia (Body Temperature is Several Degrees Above 98.6F)

Hyperthermia Symptoms include Dizziness, Lethargy, Drowsiness, and Fainting

Hyperthermia can cause:

- Fetal Damage in Pregnant Women
- Physical In-Ability to Exit the Room
- Loss of Consciousness

Notice - Use of Alcohol or Drugs Increases the Risk of Fatal Hyperthermia

If You Have any Health Problems or Health Conditions, Consult Your Physician Prior to Sauna Us, Discontinue Use if Nervousness, Tremor, Headache, Feeling of Sickness or Nausea Occurs

b. Warning (Fire Hazards):

- Do Not Use the Sauna Room for Drying Cloths, Bathing Suits, Etc.
- Do Not Hang Towels or Other Objects on Heater Grills
- Never Operate this Sauna Room if it Has a Damaged Cord or Plug

Pre-assembly Information:

- a. Two (2) adults are required for the assembly and installation of the room.
- b. Assembly Tools: Phillips Screwdriver
- c. Boxes are labeled in the order of room assembly
- d. Note: Front wall glass assembly is heavy and fragile.

Box #1: Floor, Ceiling, Bench Skirt, Bench, Manual & Deluxe Door Handle Set

Box #2: Left & Right Walls

Box #3: Front & Back Walls

Electrical Requirements: The IR Sauna Room is designed for a 120 Volt AC / 15 or 20 Amp Circuit Breaker!

A 120 Volt AC (dedicated) circuit is recommended to avoid unnecessary tripping of the breaker.

The Sauna should be plugged into a NEMA (5-15R or 5-20R) Amp electrical outlet.

IG 810SH	15 Amp
IG 820SH	15 Amp
IG 825SH	20 Amp
IG 830SH	20 Amp
IG 840SH	20 Amp
IG 870SH	15 Amp
IG 880SH	20 Amp



5-15R



5-20R



Box label will indicate the model of the room and the room serial number, the label will also give you the box number and the internal contents.

Record your model number and serial number from box in the event you should need to contact your dealer.

Serial Number _____

Model Number _____

Dealer Name _____

Sauna Assembly Instructions

Floor Panel (Box #1):

- Locate the Floor Panel on a level surface (3-6) inches from wall and no more than (5 ft) from 120 Volt AC / 20-amp dedicated receptacle.
- Position the Floor panel so that the Ceramic tiles / IR Floor Heaters are to the front of the room

Note: place the Ceiling, Bench Skirt and Bench to the side until the appropriate steps.

Note: place the power cord on the ground to the side of the floor; be sure that all wires and connectors on the sauna floor are clear of the slots.

Note – Do NOT Plug the Sauna Room 120 VAC Power Cord into the Outlet Yet!



Back Wall (Box #3):

*Note: after opening the box 3, store the front wall glass until that step of the assembly process.
Be sure to control the door from opening when moving the Front Wall Panel to prevent breakage.*

S825 Back Wall:

- Place Back Wall panel into the back slot of the Floor Panel.
- Back Wall panel must be held in place until the Right Wall panel is added.
- Move ahead to **Right Wall (Box #2):**



S830 Back Wall:

In box 3 there will be 2 panels for the back wall.



- Place Right-Back Wall panel into the rear slot of the Floor Panel.
- Back Wall panel must be held in place until the Left-Back Wall panel is installed.
- Place Left-Back Wall panel into the rear slot of the Floor Panel. Secure the wall panels together by interlocking the wall brackets between the panels.
- Continue to hold the Back Wall Panels until the Right Wall Panel is installed.

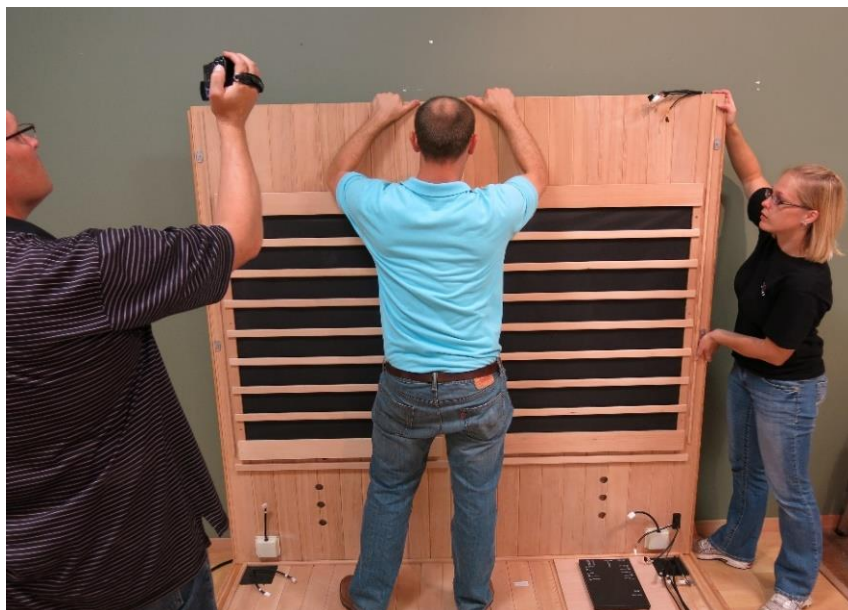

Right Wall (Box #2):

- Place Right Wall section into the right slot of the Floor Panel
- Attach Back Wall to the Right Wall by lifting up the Right Wall sliding into the corner interlock brackets.



Left Wall (Box #2):

- Place Left Wall section into the left slot of the Floor Panel
- Attach the Back Wall to the Left Wall by lifting up the left wall sliding into the corner interlock brackets.



Note: When wall panels are connected in place properly the corners will be flush on top.

Ceiling (Box #1):



- Place the Ceiling panel with the speakers towards the back of the room.
- Prop the ceiling up with the cam locks.
- Once the Ceiling panel is lined up directly above the Wall panels; insert the wires harnesses from the wall panels into the holes in the Ceiling panel.



Note: Position the cam locks on the top of the Left & Right Wall panels as shown above.

Bench Skirt (Box #1):

- Insert the Bench Skirt in between the Right Wall and the Left Wall panels tracks.
- Slide Bench Skirt all the way to the floor. Do not pinch any wires under the skirt.
- Latch the buckles securing the floor to the Bench Skirt. **Do not** latch the buckles for the left and right wall panel at this time.



Bench Top (Box #1):

- Slide the Bench seat down against the back wall with Power Junction Box facing you.
- Tilt the Bench against the Back Wall so it will remain standing.

Electrical Connections (under bench - right side):

- Connect wire #4 from distribution plate to #4 from Back Wall harness.
- Connect wire #5 from the distribution plate to #5 from the Back Wall harness.

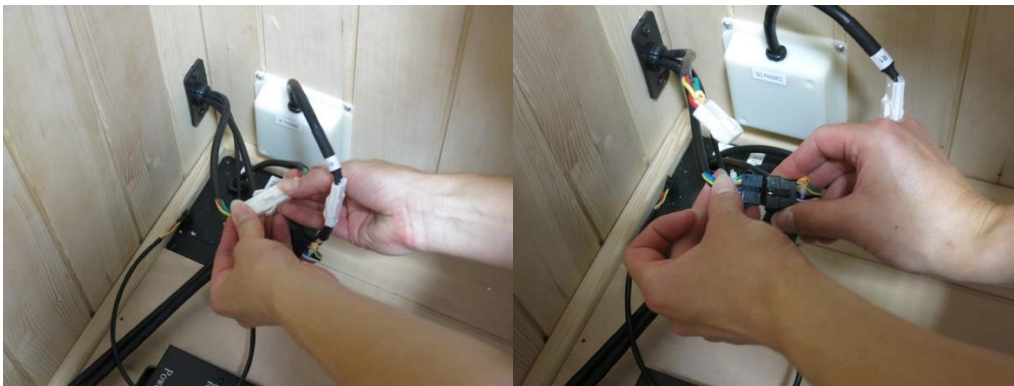

- Connect wire R1 from the distribution plate to R1 from the Right Wall junction box.



- Connect wire S3 from the distribution plate to S3 from the Bench Skirt.
- Connect wire #6 from the Back Wall harness to the Bench Top wire #6.
- Connect wire S1 from the distribution plate to the Bench Top wire S1.



Electrical Connections (under bench - left side):

- Connect wire L1 from the distribution plate to L1 from the Left Wall panel.
- Connect wire B1 from the distribution plate to B1 from the Back Wall panel.



- View of the finished connections.



- Locate the electrical switch on the black Master Control Box and ensure the switch is on.

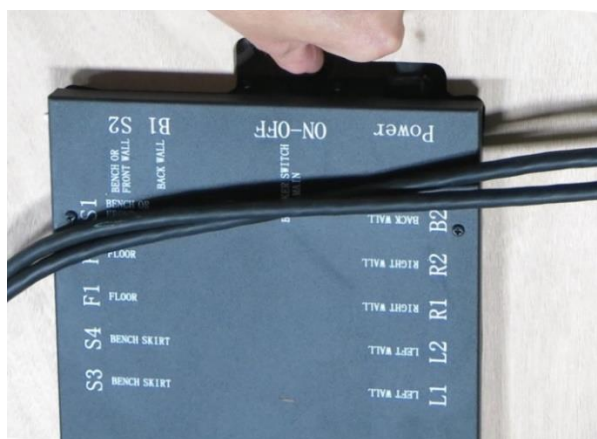

- Use the buckles to latch the skirt to the walls.

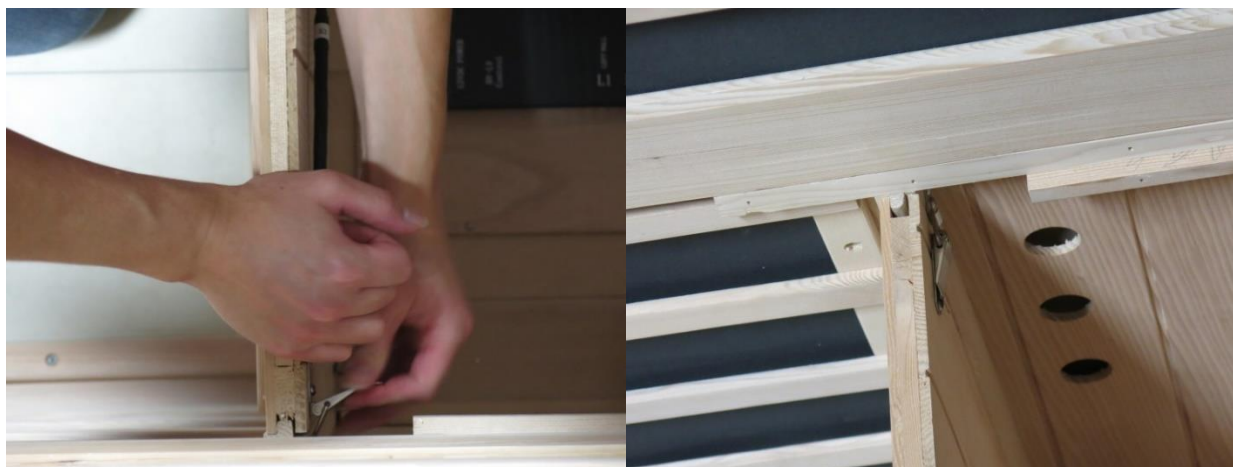

- Bench top can now be fit into place. Bench must tuck under the back-heater guard and then push all the way to the back wall.
- The Bench Top should fit down flush from front to back. It may be necessary to use the openings on the bench skirt to apply pressure either forward or rearward on the skirt to allow bench to drop into place.



Front Glass (Box #2):

Note: Use Caution while installing glass panels. Always have two people, wear grippy gloves, and do not let the glass touch hard ground; it will shatter.

- Carefully place the smaller left glass window.
- Carefully pick up the large glass piece and place the skinnier panel in the corner slot.
- Make sure the door hinges out



Note: Secure the door from falling open and breaking while setting the Front glass panels.

- Lower the Ceiling panel. ***Be sure not to pinch any wires under the Ceiling panel.***



- Turn the wood ceiling cam locks to lock the ceiling into place.

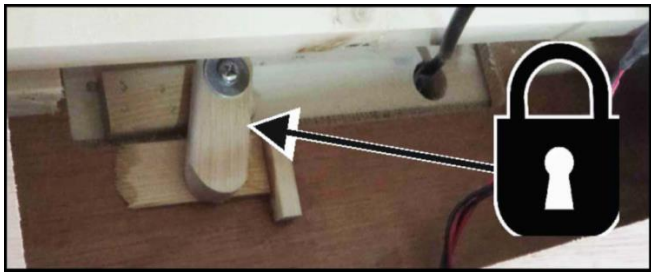

Electrical Connections (inside the Ceiling panel-back right corner):

- Open all hatch doors on the ceiling to locate the necessary electrical plugs.
- Access the connectors and connect them according to the labels on the harness.
- Connect wire #4 from the Back Wall harness to the Ceiling wire #4.
- Connect wire #5 from the Back Wall harness to the Ceiling wire #5.
- Connect wire #6 from the Back Wall harness to the Ceiling wire #6.

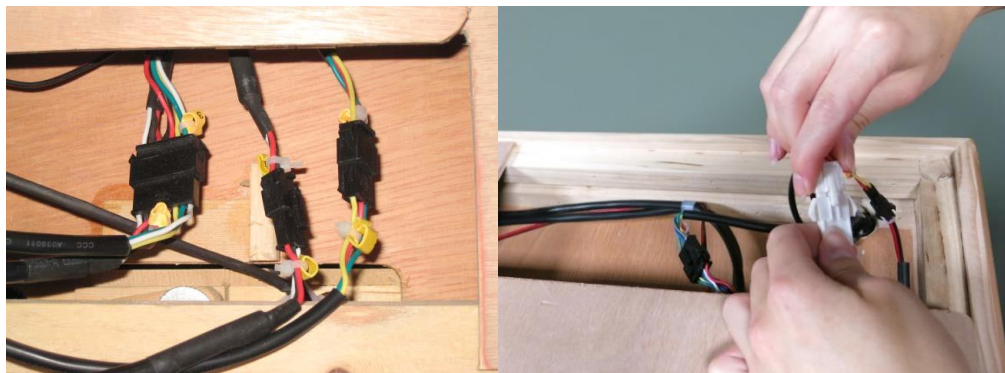

Electrical Connections (inside Ceiling-Left front corner):

- Near the Touch Screen harness in Ceiling connect Left Wall wire #3 to Ceiling wire #3.
- Connect Left Wall wire #7 to the Ceiling wire #7.
- Connect Left Wall wire F to Ceiling wire F.
- Connect Left Wall wire E to Ceiling wire E.

Electrical Connections (inside Ceiling-Left rear corner-not pictured):

- Connect the Left Wall wire #7 to ceiling wire #7.

Electrical Connections (inside the Ceiling-Right front corner):

- Connect the Right wall wire #7 to Ceiling #7 for valance lights.

Sauna Room 120 Volt AC Power Cord:

- Plug the Sauna room power cord into the 15 amp / 5-15R or 5-20R wall receptacle as noted in page 3.

Note: It is important that the sauna be plugged into a dedicated outlet of the correct rating. Plugging your sauna into a shared circuit through can cause poor performance, circuit breaker tripping, or overheating of the circuit.



Door Handles:

- Remove door handle from packaging.
- Logo Handle goes on the outside of room
- Place other handle with slot side up inside is designed to hold electronic devices.
- Secure handles together with provided



of room. Slot screws.

Control Panel Instructions:

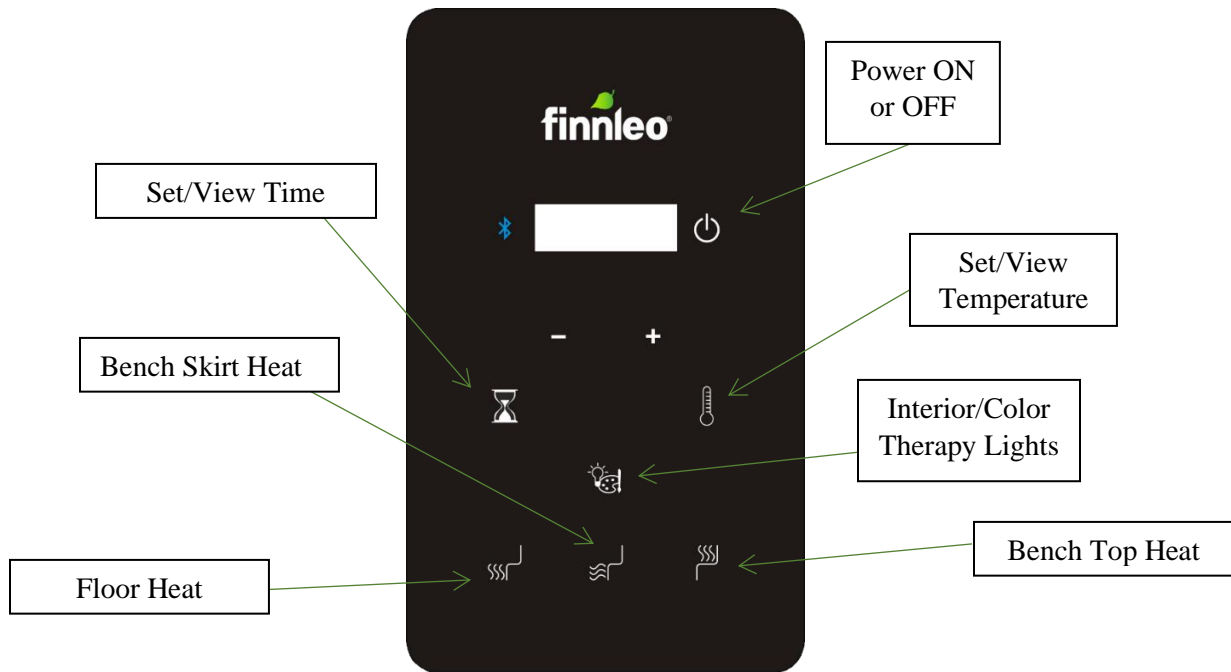

Main Power:

Press **POWER** to switch room **ON** or **OFF**

Timer Functions:

Press the Set/View Time icon to adjust or view sauna duration. Press and hold “+” or “-” to set room operating time. (15-minute increments)

Temperature Functions:

Press to alternate between either C or F (C or F will light to indicate the units desired)

Press and hold + or – to set desired room temperature setting.

Pressing once will increase or decrease the desired setting in one-degree increments.

Once the desired room temperature is set, the desired temperature will flash three (3) times

After the fourth (4th) flash, the actual room temperature will remain displayed.

Press **Bench Top Heat** to turn **ON** or **OFF**

Press **Bench Skirt Heat** to turn **ON** or **OFF**

Press **Floor Heat** to turn **ON** or **OFF**

Interior/Color Therapy Lights:

Press **Interior/Color Therapy Lights** to turn the lights on. Press the button to cycle through color options.

Note: at any point the lights can be turned off by long pressing **Interior/Color Therapy Lights** for 3 seconds.

- 1st press – White
- 2nd press – Red
- 3rd press – Green
- 4th press – Blue
- 5th press – Red-Green
- 6th press – Blue-Green
- 7th press – Red-Blue
- 8th press – Turns lights OFF

Audio System:

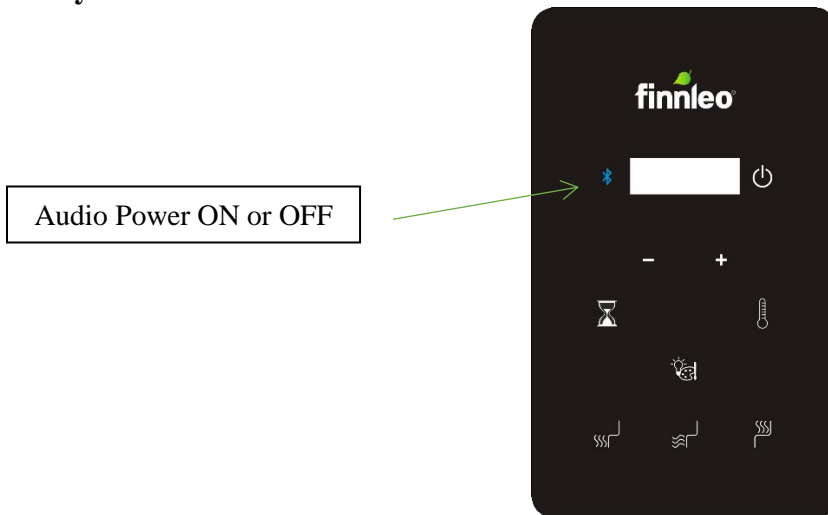

Audio Operation

Audio Power On

- Press **Bluetooth icon** to turn on or off audio system
- Blue LED indicates the audio system is operating.

Bluetooth

- Bluetooth is always enabled when blue LED is glowing.

WARNING Apple will not guarantee your Apple product if used at operating temperatures of 32°F or below and 95°F and above. The recommended operating temperature is 32°F to 95°F to fall into the warranty. Check with any other device manufactures for operation temperatures before using the device in the Sauna/IR Room.

IL2 Control is Wi-Fi Compatible:

- Download the SaunaLogic App and install onto your smart phone or tablet by scanning the QR Code below or searching for “SaunaLogic” in the appropriate app store.

(Note) The IL2 Control is completely compatible with the “SaunaLogic” App.



- Register a New Account:
 - a. When you open the SaunaLogic App for the first time,
 - b. You will be given the option to Register or Login with Existing Account.
 - c. You will need to select Register and follow the prompts to complete the registration requirements.
 - d. A valid email address or a mobile phone number will be required to complete the registration process.
- Pairing Information:
 - a. Follow the App instructions to pair the device.

Note a Change to Start Pairing of the Control

- Press and hold the “Bluetooth” button until you hear a “beep”
- Release the button and press it again immediately until another “beep”
- The control is now in “pairing” mode.
- Scan the QR Code below to access the latest Pairing Video and Instructions



How to Use Infrared Sauna:

- Avoid eating large meals and excessive alcohol intake before using Sauna.
- Never smoke or drink alcohol or exercise inside of Sauna.
- If you are taking any medications or under the care of a Physician, consult with them prior to Sauna usage. Refer to Sauna Usage Warning signs located inside of Sauna Room
- Prior to Sauna session, if possible before using Sauna, take a warm shower without drying.
- Clothing is optional or wear loose fitting clothes. You may choose to sit or lie on a clean, soft towel.
- Set desired time & temperature.
- The Sauna is producing the correct wavelengths to be absorbed into the body within 10-15 minutes of operation. It is not necessary to wait until the sauna is at maximum temperature; the absorption of wavelength is the same whether the room is in heat up or at set temperature.
- Enter Sauna and relax, you may choose to enjoy music. Refer to the above Color Therapy System instructions.
- Sit or lie on bench. Close the door and open the interior ceiling vent allowing for fresh air circulation.
- Remain in the Sauna long enough to warm up and stimulate a mild perspiration. Typically, that may occur in 10 – 15 minutes. This varies with every individual and their comfort level. Do not over do it!
- Drink plenty of cool water or a refreshing healthy drink while using the sauna.
- Leave the Sauna and cool down. Shower or bathe if possible, to cool down and cleanse the skin.
- Cool down period usually is the same length of time as the Sauna session.
- Then reenter the Sauna for another 10-15 minute session.
- Continue this process of alternating using the Sauna and Cooling Down for 3 to 4 cycles.
- Length of time in the Sauna and cool off period varies and depends on the individual.
- After final Sauna session and upon leaving the Sauna turn the Sauna off the timer if it is still operating.
- Open the door and clean the Sauna walls, bench and floor areas with a soft, clean damp cloth.
- Enjoy a final shower or bath to cool down. Relax, in the special “after sauna glow” and you may choose to enjoy a healthy snack and cool drink.

Additional Usage Warnings Located Inside Sauna Room



Maintenance / General Cleaning

Tips:

DO NOT USE: Alcohol or any strong Cleaning Chemicals

Note: Some chemicals can damage clear finish and wood surfaces.

- Interior: Perspiration and dirt may absorb into the wood, so periodic cleaning is needed, scrubbing benches, back supports, floorboards and walls with a stiff brush and mild detergent is normally sufficient. Light sanding is another option for cleaning interior surfaces.
- Exterior: Use a damp cloth of a mild soap mixed with warm water.

Trouble Shooting Tips:

a. Main Control Touch Pad Lights Not Lit:

Ensure electrical connections between ceiling and back and the ceiling and front wall
Ensure power cord is plugged in to the proper power receptacle and dedicated circuit breaker
Ensure main circuit breaker (house) is not tripped (power is found at the receptacle)
Ensure the room main controller circuit breaker (under the bench) is not tripped and is ON

b. Room not heating:

Ensure power cord is plugged in to the power receptacle
Ensure main circuit breaker (house) is not tripped (power is found at the receptacle)
Ensure the room main controller circuit breaker (under the bench) is not tripped and is ON
Ensure room desired temperature is greater than room actual temperature (controller demands heat)
Ensure that there is no time in the Delay Start timer if you do want to delay the start

c. Door rubbing or binding:

Ensure that the room is assembled properly; walls and ceiling should all be interlocked.
Ensure the floor is flat by using a level on the ceiling of the room. It may be necessary to use a small door or window shim to adjust the level under the floor.

For additional assistance or service questions?

Please contact your local dealer or outlet

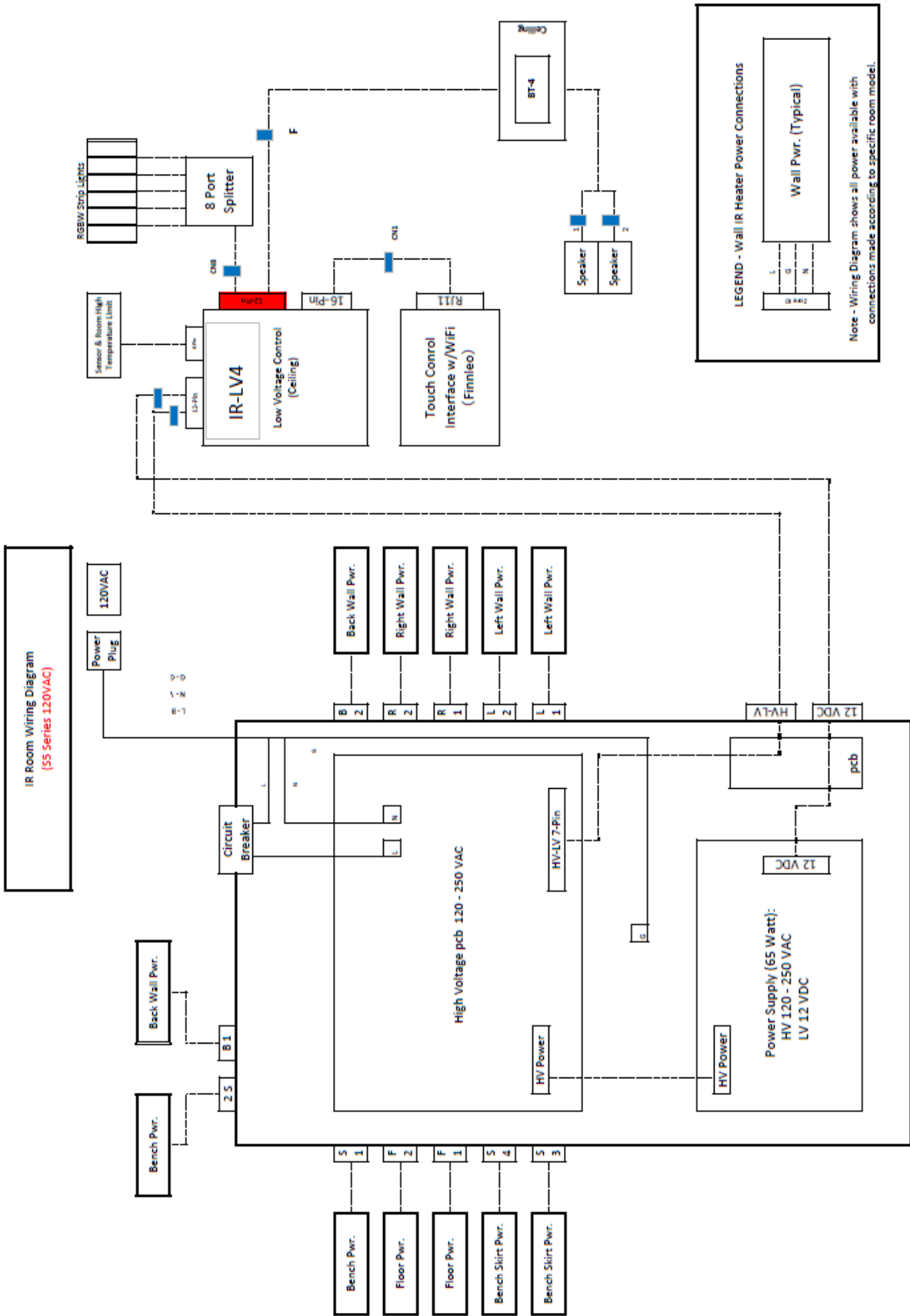

Rev. 5 2-7-2022

Sauna360, Inc. (also known as, “Finnleo”, “Tylo”, “Helo”, and “Amerec”) warrants to the original purchaser (“you”) the following regarding your new sauna, when purchased from one of our authorized retailers/service centers/“sauna specialists” (“dealers”) and the warranted product (a) is installed in accordance with installation instructions provided, (b) is properly and reasonably maintained, and (c) has not been subjected to damage, misuse, or abuse, and (d) is for residential use only.

5 Year Traditional Sauna Heater Warranty

Sauna360, Inc or its authorized representative will provide parts to replace those that have failed due to defects in manufacturing or workmanship for 5 years from the date of purchase, including freight costs for the first 5 years. The “failed” warranty item being replaced may need to be inspected at the factory prior to final warranty claim approval.

5 Year CarbonFlex™ Infrared Emitter Warranty

Sauna360, Inc or its authorized representative will provide parts to replace those that have failed due to defects in manufacturing or workmanship for 5 years from the date of purchase, including freight costs for the first 5 years. The “failed” warranty item being replaced may need to be inspected at the factory prior to final claim approval.

5 Year Wood Cabinetry Warranty

Sauna360, Inc or its authorized representative will provide parts to replace those that have failed due to defects in manufacturing or workmanship for 5 years from the date of purchase, including freight costs for the first 5 years. Since the wood used in sauna manufacturing has been kiln dried, a certain amount of expansion and contraction is to be expected in a typical sauna environment. This may result in minor cracks under normal use and is not covered under this warranty.

5 Year Sauna Control Warranty

Sauna360, Inc or its authorized representative will provide parts to replace those sauna control components that have failed due to defects in manufacturing or workmanship for 5 years from the date of purchase, including freight costs for five (5) years.

5 Year Bluetooth Sound System/Speaker Warranty

Sauna360, Inc or its authorized representative will provide parts to replace those that have failed due to defects in manufacturing or workmanship for 5 year from the date of purchase, including freight costs for five (5) years.

5 Year LED Lighting System Warranty

Sauna360, Inc or its authorized representative will provide parts to replace those that have failed due to defects in manufacturing or workmanship for 5 year from the date of purchase, including freight costs for five (5) years.

2 Year In-Field Labor Coverage

For non-commercial locations, Sauna360, Inc through its authorized representative will provide reasonable in-field labor to replace any covered defective parts for a period of two (2) years from the date of original purchase and three (3) additional years of at-the-factory labor, if the product is returned to the factory.

1 Year Commercial Application Parts-only Warranty

For commercial locations, Sauna360, Inc or its authorized representative will provide parts to replace those with defects in manufacturing or workmanship for a period of one (1) year from the original date of purchase for all components. *Other electrical components are covered under this warranty (see other sections)*

73-0124

Rev. 04-06-2022 RN

Warranty Performance

All warranty work must be (a) authorized by Sauna360, Inc. before it is performed; and (b) performed only by an authorized Sauna360, Inc. representative. This warranty shall not apply to any charges for parts or labor incurred before receiving approval by Sauna360, Inc.

Warranty Procedure

Requests for repair or replacement, a return authorization number, or warranty information should be directed to Sauna360, Inc. by calling toll-free 1-888-780-4427 or by writing to Sauna360, Inc 575 East Cokato Street, Cokato, MN 55321. Defective product or parts returned for repair or replacement must be shipped prepaid to Sauna360, Inc. at the above address. Shipping costs for return of replacement product or parts to the purchaser will be at the expense of Sauna360, Inc..

Return Authorization

A Return Authorization number assigned by a Sauna360, Inc. representative must accompany all returned parts. Parts that are returned without a Return Authorization number may not be repaired or replaced.

NOTE: Out-of-warranty replacement parts carry a 30-day warranty on the part only.

Limitations, Exclusions, and Remedies

There are no warranties which extend beyond the descriptions of the face hereof. This limited warranty is in lieu of all warranties, expressed or implied, and of all other obligations or liabilities on the part of Sauna360, Inc. There shall be no implied warranty of merchantability. Sauna360, Inc. neither assumes nor authorizes any person to assume for it any other obligation or liability in connection with the sale of its products.

Damages for breach of this warranty shall not exceed the lesser of the cost of repair or replacement. Repair or replacement shall be the exclusive remedy available to the purchaser.

Under no circumstance shall Sauna360, Inc. be liable by virtue of this warranty or otherwise for any special, indirect, secondary, incidental, or consequential damage of any nature to any person or property arising directly or indirectly out of the use or inability to use a warranted product.

Some states do not allow limitations on how long an implied warranty lasts, or the exclusion of limitation or incidental or consequential damages, so the above limitations and exclusions may not apply to you.

This warranty does not apply to damaged caused by Acts of God, misuse, abuse, negligence, accident unreasonable use, or by causes unrelated to defective materials or workmanship.

A valid proof of purchase in the form of a bill of sale or receipt from a retailer with the date of original purchase may be required to obtain warranty service.

Disputes

Any lawsuit alleging breach of this limited warranty shall be commenced within one (1) year from the date of breach.

This warranty gives you specific legal rights, and you may also have other rights, which vary from state to state or province to province.

Registration

This limited warranty becomes valid only after the [Limited Warranty Registration Form](#) is completely filled-in and submitted to Sauna360, Inc. within sixty (60) days from the date of original installation. This warranty is non-transferrable and shall extend to the original purchaser only. The warranty registration form may be accessed by visiting <https://www.sauna360.net/warranty> or scanning the QR code below:

