

# helo

COMMERCIAL

DRAWING #

3041482-01

INVOICE # C-ADA

COMPANY: Community Center  
JOB NAME: Shakopee

WOOD TYPE: CEDAR

T&G DIRECTION: VERTICAL

ROOM HEIGHT: 86"

JOIST DIRECTION: Front to Back

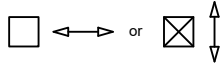

SQ. FOOTAGE: 154.4

Door Size/Style DF 36X80

Door Jamb Width 5-3/8"

Interior Upgrade -

Htr. Size/Model (2) PRO 12.0

Control Type (2) SC-CLUB

Voltage/Phase 208V/3P

Lighting Option (2) WALL

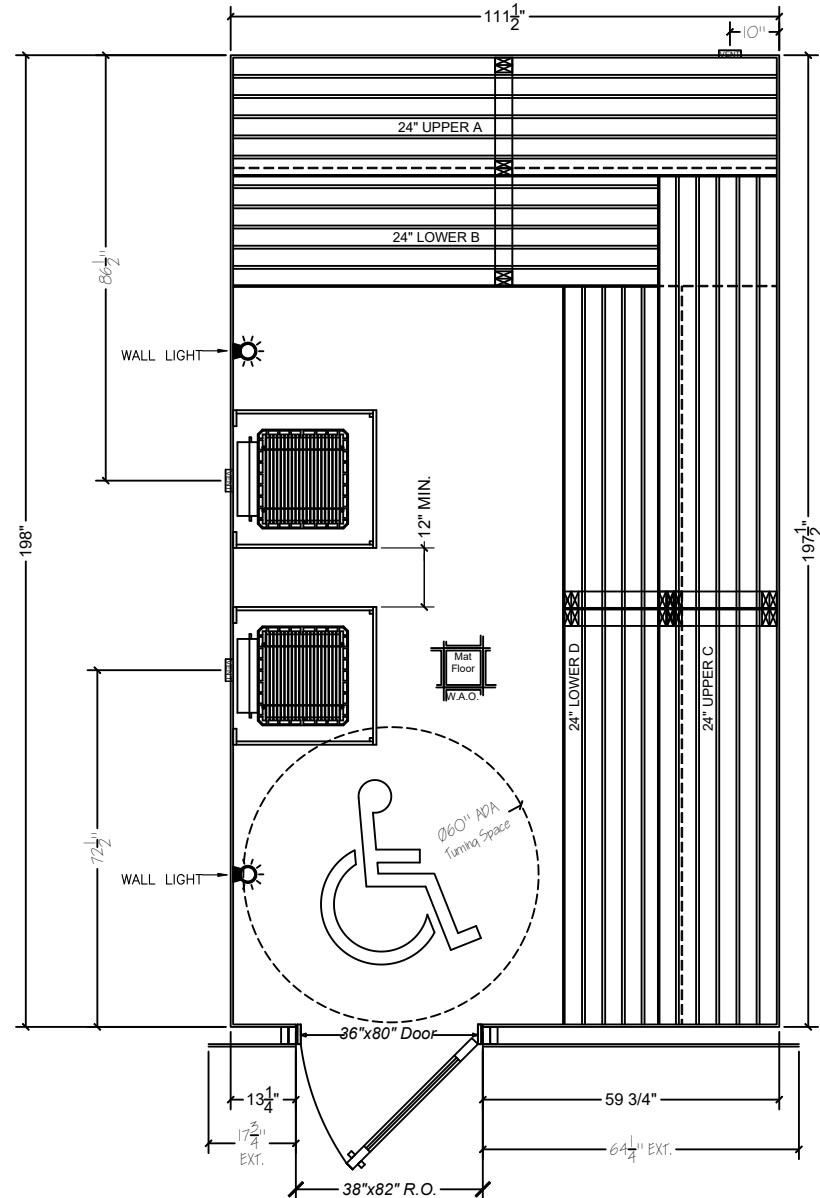

NOTE: EXTERIOR T&G TO BE APPLIED TO WALLS O.S. DOOR - VERTICAL  
7 PCS DOOR TRIM @ 96" LONG  
208 L.F. OF T&G (26 PCS @ 96" FOR OUTSIDE WALL) - 2 PCS CORNER TRIM @ 96" LONG

See construction standards for drawing assumptions

DATE: 3-29-17

pre-cut sauna